

A STORM SEWER COMPACTED FILL SECTION
NO SCALE

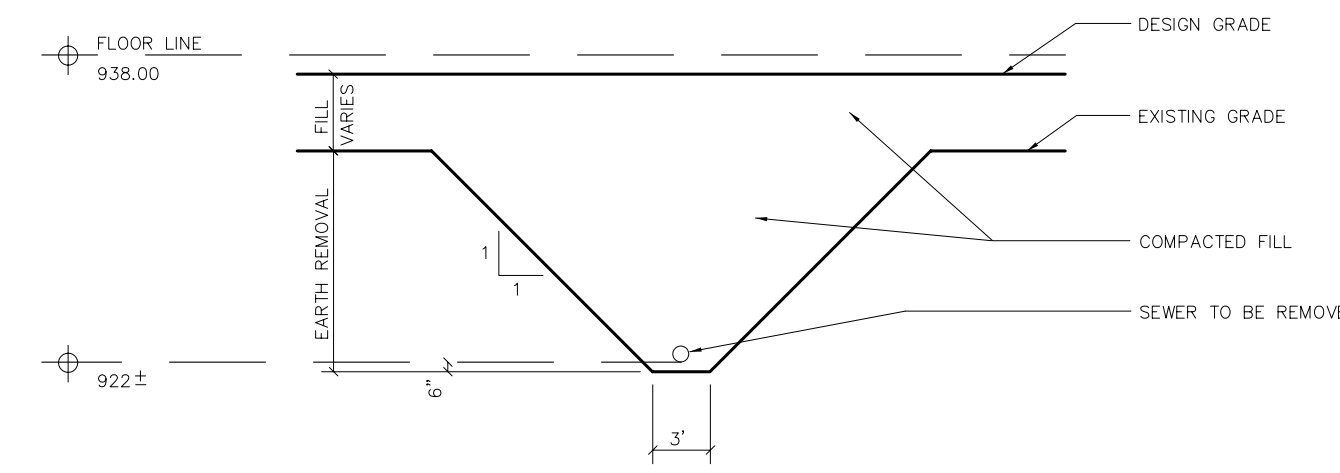

B SANITARY SEWER COMPACTED FILL SECTION
NO SCALE

- GENERAL NOTES
1. TOPOGRAPHY SURVEY PREPARED BY SNYDER & ASSOCIATES DATED 12-4-92
 2. GEOTECHNICAL EXPLORATION AND REPORT HAS BEEN PREPARED BY ALLENDER BUILDING ENGINEERS, INC. DATED
 3. VERIFY AND DO NOT DISTURB EXISTING UTILITIES UNLESS INDICATED. SEE SPECIFICATIONS.
 4. PHASE 1 CONTRACTOR SHALL INSTALL SILT FENCING INDICATED AS MINIMUM EROSION CONTROL. PROVIDE ADDITIONAL EROSION CONTROL AS REQUIRED TO PROTECT STORM SEWERS AND EROSION TO ADJACENT SITES. PHASE 2 CONTRACTOR SHALL REMOVE.
 5. TREES SHOWN WITH X WILL BE RELOCATED BY OWNER. OTHER TREES SHALL BE PROTECTED BY CONTRACTOR.
 6. PHASE 1 CONTRACTOR SHALL PROVIDE CONSTRUCTION FENCE.

Bench Mark: Arrow on Fire Hydrant at S.E. Corner Building #2. 70' S.E. of Building Corner. Elev. = 943.14

Note: No Underground utilities were researched or are Shown as a Part of this Survey. Contractors and/or Others are Responsible for determining utilities Which May Exist and Their Locations.

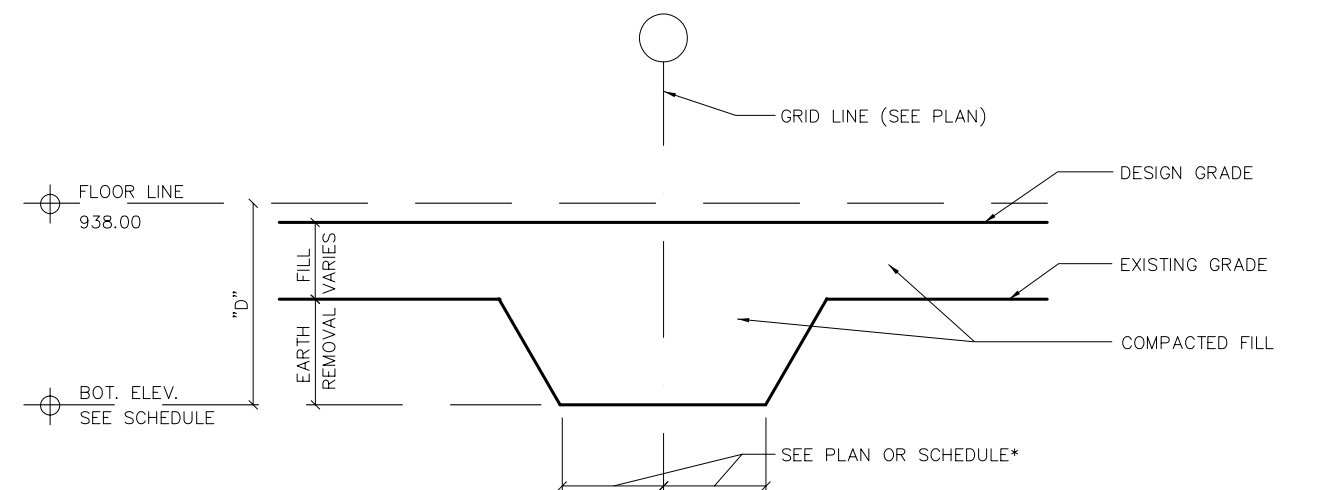
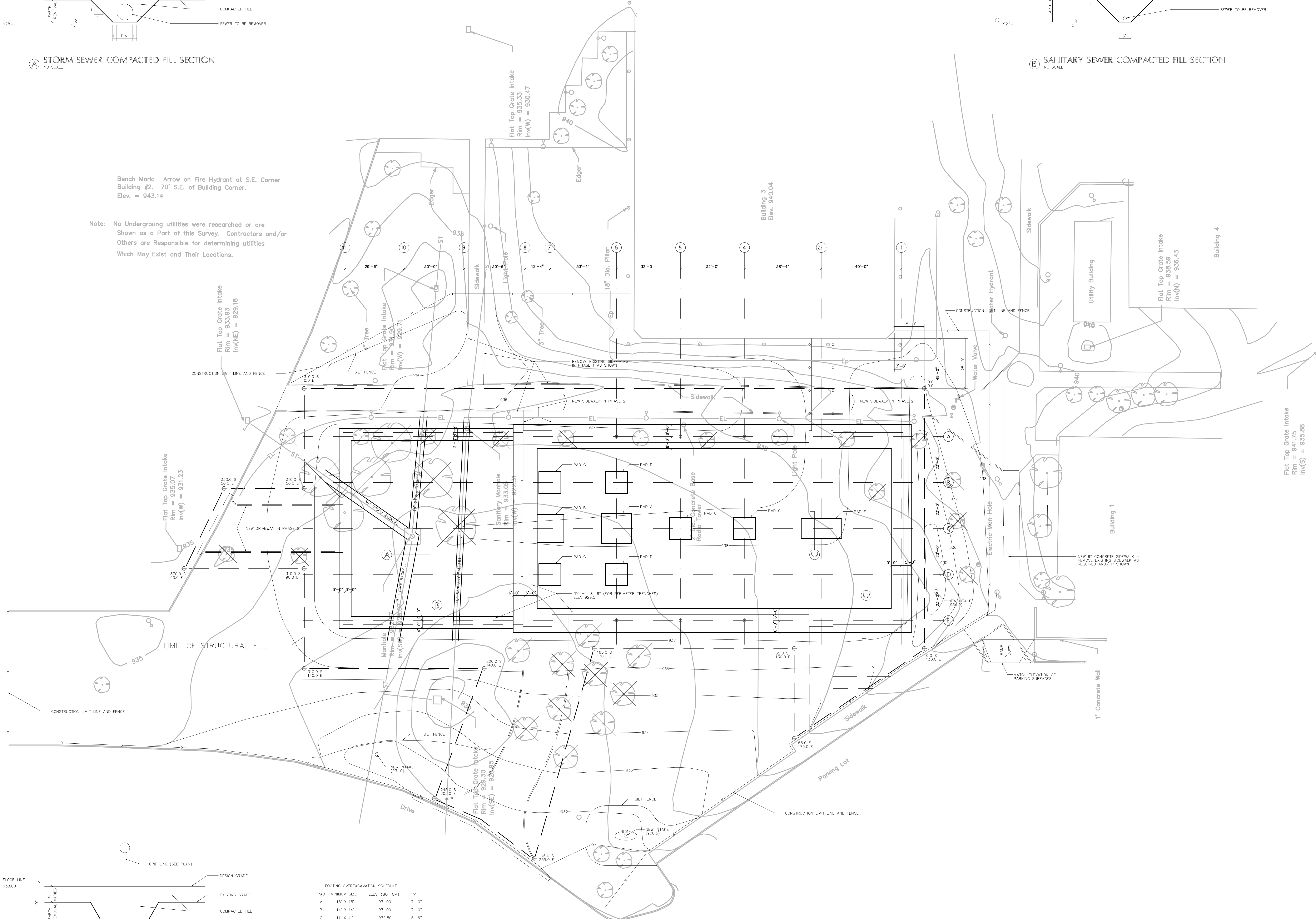

C FOOTING OVEREXCAVATION SECTION
NO SCALE

* FOOTING OVEREXCAVATION IS CENTERED ON GRID LINE UNLESS SHOWN OR NOTED OTHERWISE.

PAD	MINIMUM SIZE	ELEV. (BOTTOM)	"D"
A	15' x 15'	931.00	-7'-0"
B	14' x 14'	931.00	-7'-0"
C	11' x 11'	932.50	-5'-6"
D	11' x 11'	932.50	-5'-6"
E	10' x 20'	932.50	-5'-0"

SITE PLAN
1" = 20'

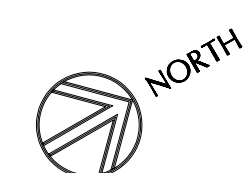

ADVANCED TECHNOLOGY CENTER - DMACC
ANKENY, IOWA

SP1

Date: JUNE 7, 1993